



Deep Sea Fishing Tackle Set Seaborg Saltwater Electric Jigging Reel 500MJ-AT

Our Product Introduction

for more products please visit us on fishing-set.com

Basic Information

- Place of Origin: Shandong, China
- Brand Name: Sunrise
- Certification: ISO
- Model Number: 4421
- Minimum Order Quantity: 20 Pieces
- Price: 1065 USD/Piece
- Packaging Details: Negotiated / Standard Package
- Delivery Time: Negotiated / 20 Working Days After Payment
- Payment Terms: T/T
- Supply Ability: 10000 Pieces/Month



Product Specification

- Product Name: DAIWA Electric Count Fishing Reel
- Fishing Method: Bait Casting
- Gear Ratio: 3.6 : 1
- Weight (g): 1010
- Fishing Reels Type: Hand Wheel, Fish Line Wheel, Electric Count Wheel, Bait Casting Reels, Sea Fishing Reels
- Position: Ocean Beach Fishing, Ocean Boat Fishing, Ocean Rock Fishing
- Single Gross Weight: 2.500 Kg
- Ship From: Shandong, China
- Highlight: Deep Sea Fishing Tackle Set, Fishing Tackle Set Seaborg, Saltwater Electric Jigging Reel



More Images



Product Description

DAIWA Seaborg Deep Sea Saltwater Electric Jigging Reel 500MJ-AT

About this item

- Gear Ratio: 1.5 inches (3.7 cm), Winding Length (per handle): 22.4 inches (57 cm), Maximum Drag Force: 8.1 lbs (23 kg), Body Weight: 2.4 oz (1,010 g)
- Standard winding amount: Nylon (No. - m) 6 - 350, 7 - 300, 8 - 250 / PE (No. - m) 4 - 500, 5 - 400, 6 - 300
- Bearing (ball/roller): 22/1
- Maximum Winding Force (kg): 29.4 lbs (90 kg) (when using Super Lithium : 100) / Normal Winding Speed : 2.2 lbs (1 kg) Load (m/min): Hi 180, Lo 125 (When using Super Lithium: Hi 200, Lo 140)
- JAFS Standard Winding Force: 45.5 lbs (22 kg) / JAFS Standard Speed (m/min): Hi 230, Lo 150

基本操作手順

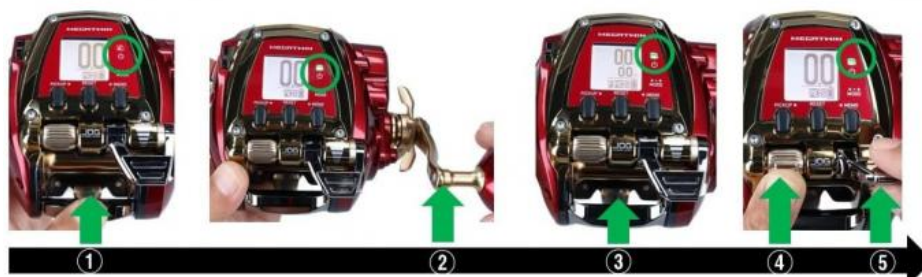

①クラッチOFF	仕掛け投入/LED:赤点灯
②手動クラッチON	通常使用時(モード設定無)⇒ハンドル回転でクラッチON/ LED:緑点灯
③自動クラッチON	フカセモード/自動棚停止設定時⇒自動でクラッチON/ LED:緑点灯
④JOG巻き上げ ⑤パワーレバー巻き上げ	棚取り・誘い・アフセ・巻き上げ/LED:緑点灯



ドット液晶

- メニュー画面のアナウンスが明確で各種設定はマニュアル要らず。
※メニュー画面：PICKUPとMEMOを同時に2秒押し
- 逆光にも強く視認性に優れフィールドで見やすいデカ文字。
※偏光グラス使用時でも明確に見える。
- 水深カウンター「00」より巻上しない。
- 電源ON時Dベックを表記。

Product Description

Mega Power & Mega Speed AUTOMATIC MEGA MONSTER Mega Power & Mega Speed Electric with Aluminum JOG / New Fukasetch Clutch System with Auto Shelf Stop Function on Seaborg 500MJ Base. This flagship model is compatible with a wide range of targets from Hiramasa Bri blues and slurmé and medium deep root fishes to brown fukasehiramasa. The heart part is equipped with a MAGMAX motor that combines torque and explosive power. The motor housing is made of aluminum material, and the tough setting is heat dissipating and durable. The MEGATWIN-PRO allows you to switch between power and speed gears comfortably without the shock of the transmission. In addition, the tough drag ATD continues to work smoothly, so you can rest assured that even if you are unexpected big objects. In terms of maneuverability, it uses a one-hand comfortable operation aluminum JOG power lever that does not pass the leadership in an instantaneous wind. In addition, the fall brake dial allows you to set the speed of the drop instantly, and comes with a drop bait, making it an excellent way to capture the interlayer response of the Slu-Maker. Waterproof and durable technology MAGSEA LED ball bearing for durability maintains initial performance. In addition, the counter part features a large dot LCD that allows you to see clearly even when using polarized glasses. The new Fukasetch System and Auto Shelf Stop Feature are added. AUTOMATIC MEGA MONSTER for all of your target anniversaries.

SPEC

SEABORG 500MJ-AT

アイテム名	巻取り長さ (cm/1回転)	ギア比	自重 (g)	最大 ドラグ力 (kg)	標準巻糸量: ナイロン (lb-m)
500MJ-AT	57	3.7	1010	23	6-350 7-300 8-250

標準巻糸量 :PE (号-m)	ベアリング (ボール /ローラー)	最大巻上力 (kg)	常用巻上 速度 1kg負荷時 (m/分)	JAFS基準巻上力 (kg)	JAFS基準巻上 速度 (m/分)
4-500 5-400 6-300	22/1	90 (100)	H:180/L:125 (H:200/L:140)	22	H:230/L:150

※表内の（ ）内の数値はスーパーリチウムを使用した場合の概算値です。

おすすめターゲット

- ・ 北海道/東北 : アキアジ/タラ/ブリ/スルメ/キンキ/ソイ
- ・ 関東/中京 : ワラサ/ブリ/ヒラマサ/スルメ/カツオ/アカムツ
オニカサゴ/ライトキンメ/ムツ
- ・ 関西/山陰 : ヒラマサ/マダイ/メジロ/ブリ/メダイ/マイカ
- ・ 九州 : ヒラマサ/ブリ/ボッコ/マイカ
- ・ 韓国/台湾 : タチウオ



Qingdao Sunrise Intelligent Manufacturing Energy Technology Co.,Ltd



sunrise.imet@gmail.com



fishing-set.com

Zhongyi 1688 Creative Industry Park, No.398, Heilongjiang Middle Road, Licang District, Qingdao City,
Shandong Province, China